

Wiring Diagram – Yamaha G19/G22

Using TSX Harness Navitas PN: 40-000514

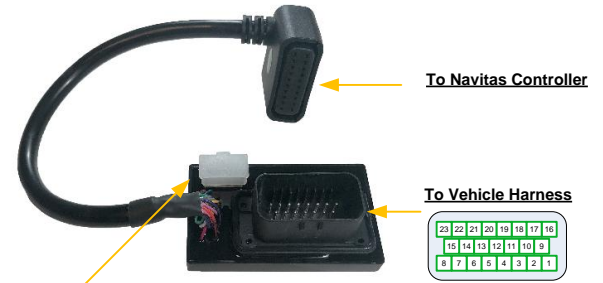
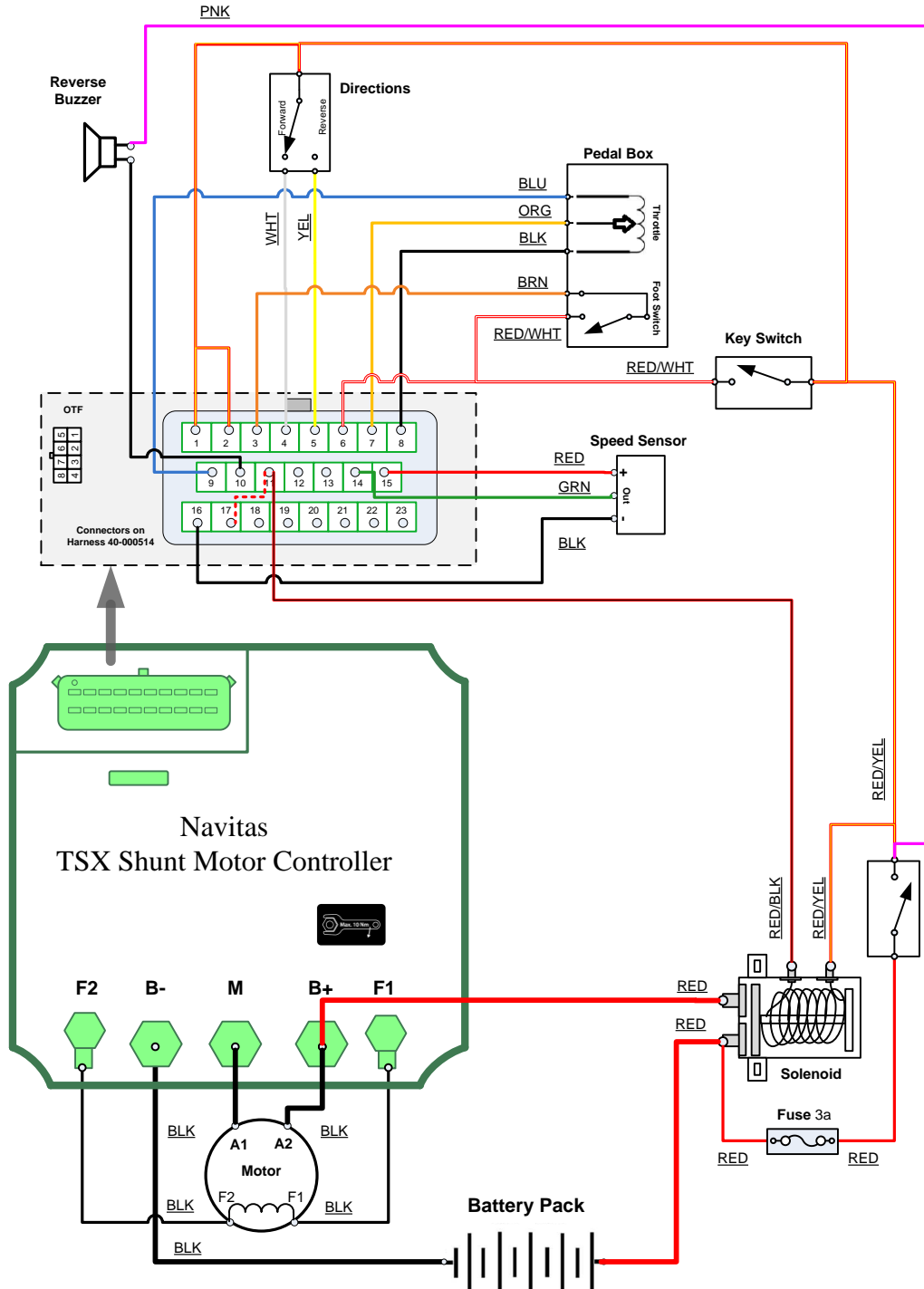

To Navitas Controller

To Vehicle Harness



23-POS Ampseal
776228-1

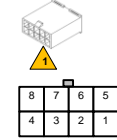

8 POS Molex
39-01-3089 Housing
39-00-0040 Pin

On The Fly Programmer

- P1: +12V POLY
- P2: OTF REGEN
- P3: OTF SPEED
- P4: OTF ACCELERATION
- P5: +5V EXT
- P6: OTF LOCK
- P7: REVERSE BUZZER
- P8: GND POLY

Navitas TSX DC Shunt Controller

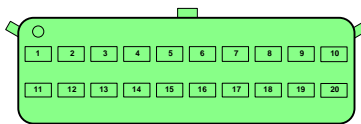

- P1: OTF LOCK
- P2: XCAN_N
- P3: XCAN_P
- P4: SPEED SENSOR SIGNAL
- P5: CHARGER INTERLOCK
- P6: REV IN
- P7: FWD IN
- P8: KEY
- P9: GND
- P10: LOGIC POWER
- P11: +5V EXT
- P12: OTF ACCELERATION
- P13: OTF SPEED
- P14: OTF REGEN
- P15: THROTTLE IN
- P16: +12V POLY
- P17: FOOT SWITCH
- P18: GND POLY
- P19: REVERSE BUZZER
- P20: LINE CONTACTOR

Mating 23 POS
TE 770680-1



Revision History

- 20210415 Original
- 20210818 Added P17 and dot line to P11