

Wiring Diagram – Yamaha G29

Using TSX Harness Navitas PN: 40-000513

Warning: Read instruction to split B- and A2, before connect any wires!

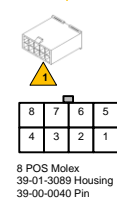
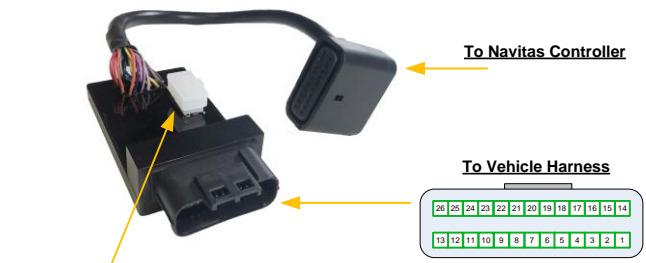
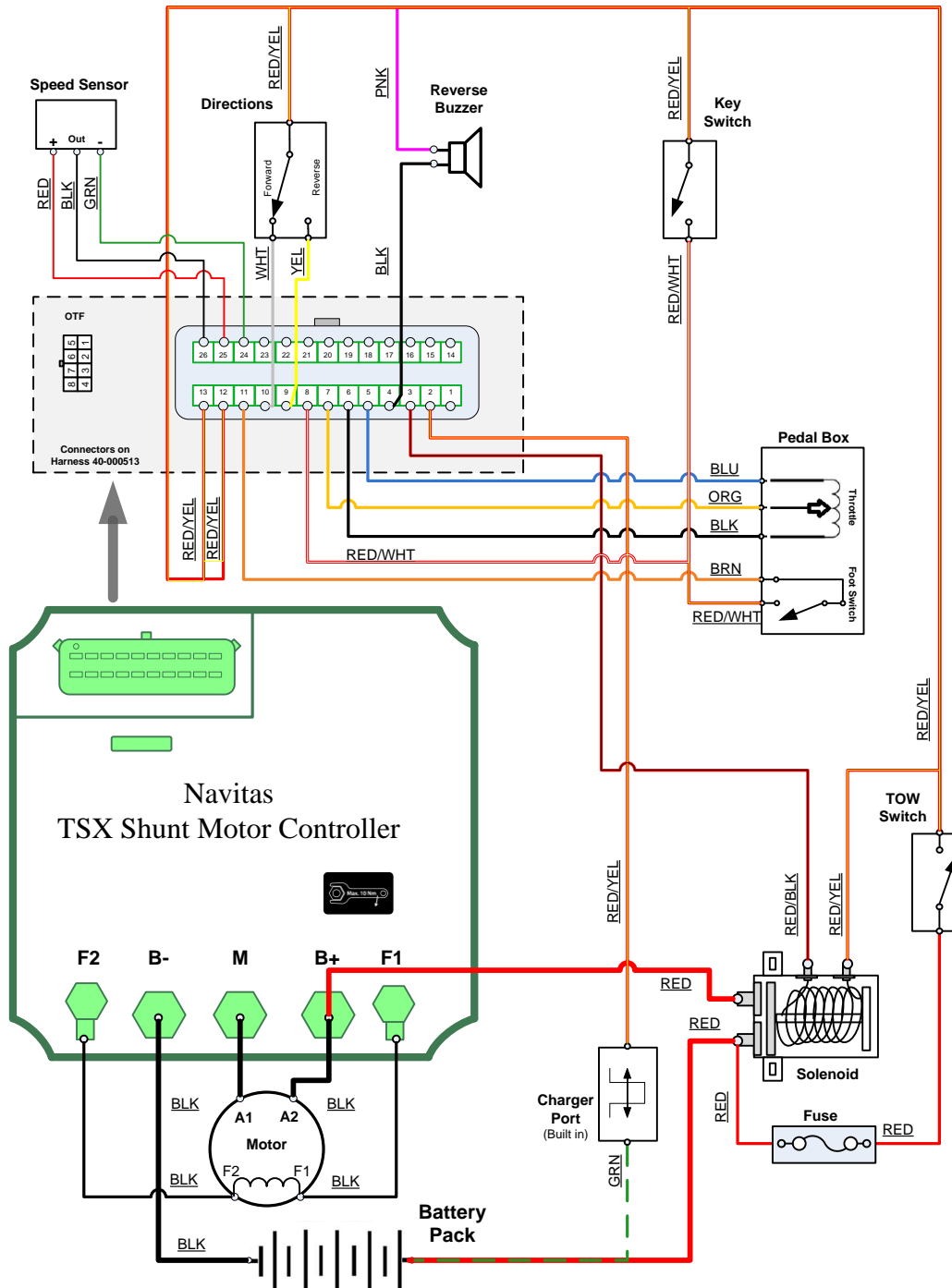

On The Fly Programmer

- P1: +12V POLY
- P2: OTF REGEN
- P3: OTF SPEED
- P4: OTF ACCELERATION
- P5: +5V EXT
- P6: OTF LOCK
- P7: REVERSE BUZZER
- P8: GND POLY

Navitas TSX DC Shunt Controller

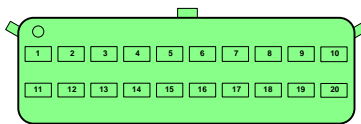

- P1: OTF LOCK
- P2: XCAN_N
- P3: XCAN_P
- P4: SPEED SENSOR SIGNAL
- P5: CHARGER INTERLOCK
- P6: REV IN
- P7: FWD IN
- P8: KEY
- P9: GND
- P10: LOGIC POWER
- P11: +5V EXT
- P12: OTF ACCELERATION
- P13: OTF SPEED
- P14: OTF REGEN
- P15: THROTTLE IN
- P16: +12V POLY
- P17: FOOT SWITCH
- P18: GND POLY
- P19: REVERSE BUZZER
- P20: LINE CONTACTOR

26 POS JAE
MX23A26NF1

- P1: NA
- P2: Charger Interlock In
- P3: Main Solenoid Out
- P4: Reverse Buzzer Out
- P5: +5V PF
- P6: GND Poly
- P7: Throttle In
- P8: Key In
- P9: Reverse In
- P10: Forward In
- P11: Foot Switch In
- P12: Logic Power In
- P13: Logic Power In
- P14: NA
- P15: NA
- P16: NA
- P17: NA
- P18: NA
- P19: NA
- P20: NA
- P21: NA
- P22: NA
- P23: NA
- P24: GND Poly
- P25: +5V PF
- P26: Speed Sensor

Mating 26 POS
MX23A26SF1



Revision History

20210415 Original